

Smart Video Doorbell

# User Instructions

## Table of contents

What's included	1
-----------------	---

---

Get to know your doorbell	2
---------------------------	---

Doorbell front view	2
Doorbell rear view	3
Functional views	3
Chime front view	4
Chime rear view	4

---

Set up your doorbell	5
----------------------	---

Downloading and installing the app	5
Doorbell binding	6
Doorbell sharing	8
Power on/off & Network configuration	9
Connecting the chime	9
Charging your doorbell	12

Installation	13
--------------	----

Retrofitting installation (optional)	13
Wireless installation	21
Installing at an angle(optional)	24
Detach and alarm	27

---

Product specifications	28
------------------------	----

LED indicator explanation	28
Video doorbell specifications	29
Wireless chime specifications	30

---

Firmware upgrade	31
------------------	----

---

FAQ and troubleshooting	31
-------------------------	----

## What's included



Doorbell



Flat mounting  
bracket



3M tape



Doorbell chime



Removal pin



Wiring cap  
(optional)



Wedge  
screw



Wall screw (wall anchor)

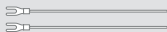

Doorbell installation wire



USB cable

### Note

Micro SD card and power adapter  
are not included

## Get to know your doorbell

### Doorbell front view

- ① Lens
- ② Human body infrared sensor
- ③ Doorbell button
- ④ Speaker
- ⑤ Removal hole
- ⑥ Microphone
- ⑦ Infrared light
- ⑧ Indicator light

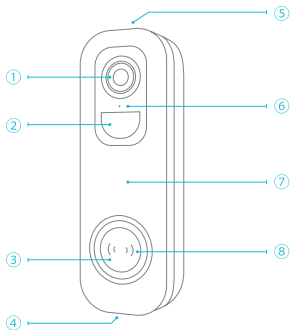

## Functional views

Left side  
Functional  
views ▶

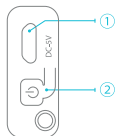

Right side  
Functional  
views ▶

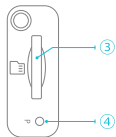

## Doorbell rear view

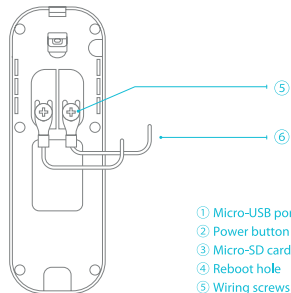

- ① Micro-USB port
- ② Power button
- ③ Micro-SD card slot
- ④ Reboot hole
- ⑤ Wiring screws
- ⑥ Doorbell installation wires

## Chime front view

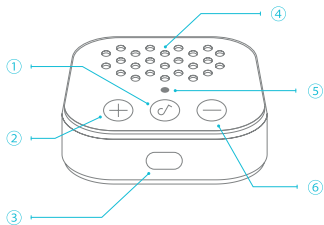

- ① Ringtone selection key
- ② Volume up key

- ③ "SYNC" key
- ④ Speaker

- ⑤ Indicator light
- ⑥ Volume down key

## Chime rear view

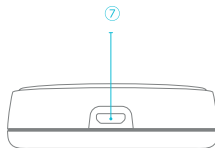

- ⑦ Micro-USB port

# Set up your doorbell

## Downloading and installing the app

The doorbell can be connected to and operated through smart phones running on Android and iOS platforms. For your best experience, please scan the QR code below, download and install the latest version app and follow the prompts to complete user registration.



App Download

## Doorbell binding

1) Click the " **Add Now** " button in the app, press and hold the doorbell switch button for 3 seconds to turn on the doorbell, and the app will automatically search for devices that are on and not bound. Select the device you want to bind in the search results for the next step.

2) Enter the name and password of the Wi-Fi network you want the doorbell to connect to. Click Next after completion, and the app will try to connect the doorbell to the Wi-Fi.

### Note

To ensure a long-distance connection, the doorbell only supports a 2.4 GHz Wi-Fi network with stronger wall penetration capability and does not support Wi-Fi with enterprise-level authentication. Please make sure that your Wi-Fi meets the requirements.

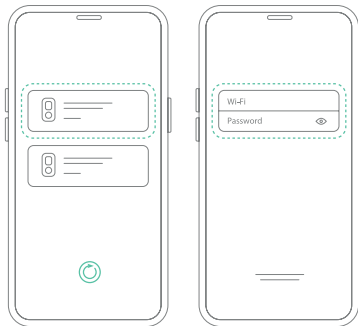



3) After a while, the doorbell will play a sound indicating that the connection is successful. At this point, please set a name for the doorbell on the app and select the location where you want to place the doorbell. Click Finish to complete the pairing.

## | Possible problems with binding

- When you hear " **Password error** ", check if the Wi-Fi password you entered in the app is correct;
- When you hear " **Authentication method error** ", please make sure that your Wi-Fi network is not in an enterprise-level network connection mode, as the doorbell only supports networks with a security level below WPA-2;
- When you hear " **AP does not exist** ", please check if you have selected or entered the correct Wi-Fi name. Please place the doorbell near the Wi-Fi router and make sure the router is powered on. Also, please note that 5 GHz Wi-Fi cannot be searched by the doorbell either;
- When you hear " **IP acquisition timeout** ", it means that you have too many devices connected to the router and to connect more devices, please delete some infrequently used devices or reboot the router to clear the unconnected doorbell whose lease has expired, and you may need to contact the router administrator;
- When you hear " **Server connection failed** ", please check if your router is properly connected to the external network. This is usually the case when your home network is disconnected or the router you choose is a server on the LAN. Please make sure the network connection is normal, and try to connect again by temporarily turning off the firewall.

## Doorbell sharing

You can use this feature when you need to use the doorbell with other family members or friends. Only the admin user who has bound the doorbell for the first time can share and set up the doorbell, while other members can only view the live video or video playback feature of the doorbell.

1) For admin user of the doorbell, find the doorbell you wish to share on the app homepage or doorbell settings screen, then click the share button and enter the Share page. Click " [Device Sharing](#) " to generate a shared QR code.

2) For users who need to be shared with, click " [+](#) " on the homepage and select " [Add Friend's Device](#) " to enter the scan code page.

3) After the shared user successfully scans the QR code on the admin user's mobile phone, the admin user will receive a confirmation notification, then click " [Accept](#) " to complete the doorbell sharing.

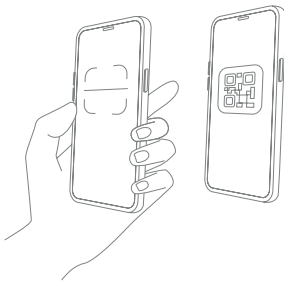

## Power on/off & Network configuration

The power button can control the doorbell on/off function or enter the network configuration mode. You need to first remove the doorbell from the bracket before the button can be pressed.

- Insert and press the detaching pin into the hole on the top of the doorbell and then lift to take the top of the doorbell off.
- Press and hold the power button for 3 seconds to switch the device on and off.
- Double-click the power button on the doorbell that has been powered on and a prompt tone will sound indicating to enter the network configuration mode.

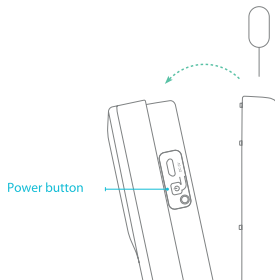

## Connecting the chime

### 1) [Connecting the doorbell chime with a charger](#)

Connect the doorbell chime to the power supply of 5V/1A~5V/2A, and the doorbell chime will ring once.

## 2) Bringing your doorbell close to the chime

Move the doorbell within 2 meters of the doorbell Chime, so that the doorbell and the doorbell chime can be paired stably.

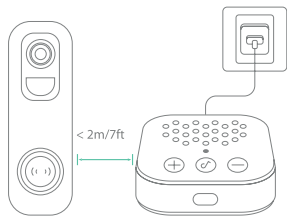

## 3) Putting the doorbell chime into sync state

Press and hold the " SYNC " button on the side of the doorbell chime until the indicator light flashes.



#### 4) Synchronizing the doorbell with the chime

Press and hold the doorbell button for 6 seconds, the doorbell will ring twice, send a connection signal, and the doorbell chime will ring.

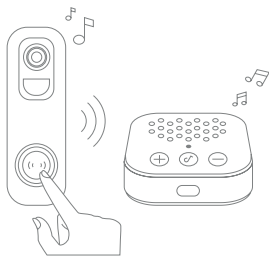

#### 5) Connection Successful

Press the doorbell button for testing. When a chime rings, it indicates that the connection is successful.



**Note**

- Your doorbell communicates with the chime via Radio Frequency, but not Wi-Fi.
- You can assign different chimes as needed.

## Charging your doorbell

Before the doorbell installation, please charge your doorbell. During the charging process, the yellow indicator light of the doorbell is always on, and then it will become solid green when the charging is completed. It may take about 10 hours to fully charge the doorbell.

**Note**

- Compatible charger (not included)
- USB compatible mobile phone charger (DC 5V 1A~2A)

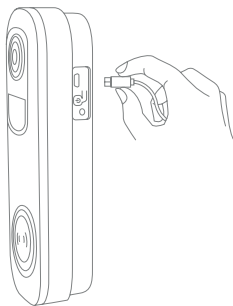

# Installation

## Retrofitting installation (optional)

Your doorbell comes with a built-in battery pack, and it also works with the existing 8V~24V AC hardwire power source. It enables you to make use of your legacy doorbell wiring for retrofitting installation.

### Note

- Use a multimeter to test the voltage.
- Check if the voltage is printed on the transformer that supplies power to your existing doorbell.

### You need

- The items in the Smart Video Doorbell box
- Phillips screwdriver
- (Optional) power drill

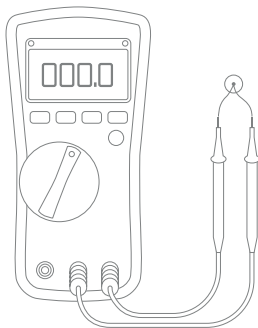

To replace your existing doorbell, please follow below installation steps:

- 1) **Shut off the master circuit breaker in your house.**



Failure to turn off your power might result in serious injury.

- 2) **Select a location for your video doorbell.**

Determine the mounting position of the doorbell. Check if you can reuse the existing holes on the wall, if you don't want to drill new holes to mount your video doorbell.

It is suggested to mount the doorbell at least 4 feet (120 cm) above the ground for the optimal angle of view and best motion detection performance.

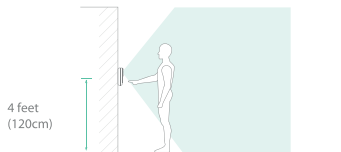

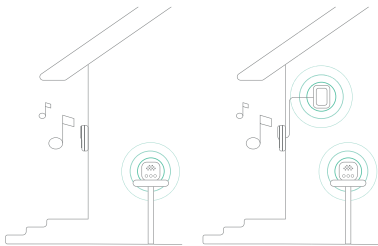

**Note**

- The doorbell, indoor unit, and router need to be as close as possible (to avoid networking failure due to distance).
- The doorbell should be installed on non-metallic porches and walls (to avoid signal shielding) or affixed to the wall on the door side.

3) If installing on stucco, brick, or concrete, mark 2 drill holes using the doorbell bracket as a template. Then, use a 1/4" masonry drill bit to drill holes in your wall, and insert the included anchors. (If you're installing on a wood surface, skip this step.)

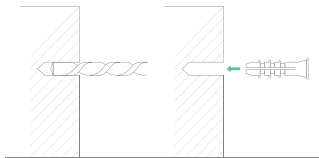

## Replace your existing doorbell

schematic diagram ▼

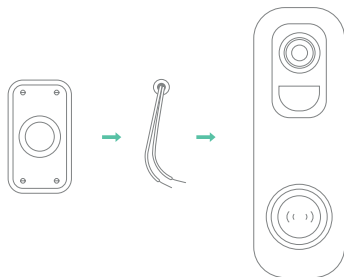

mounting order ►

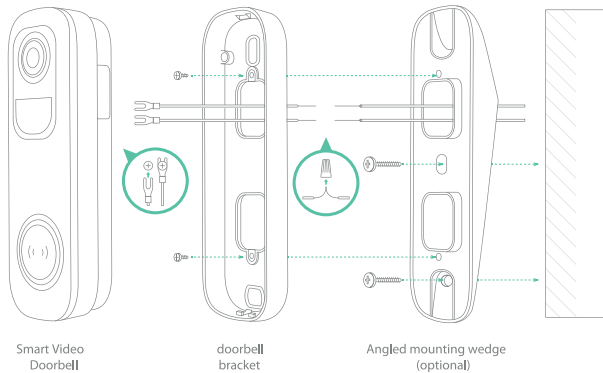

## Installation steps

1) Remove the existing doorbell from the wall and disconnect the wires.

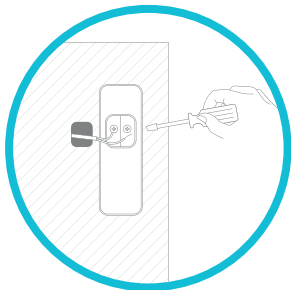

2) Release the bracket from the doorbell with the provided tool.

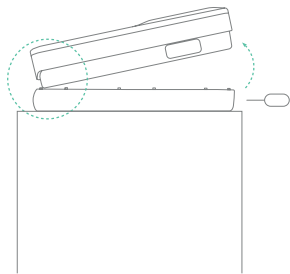

3) Lead the wire through the holes on the bracket before mounting.

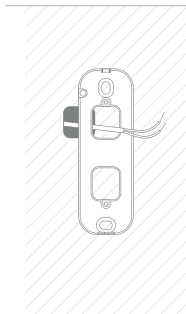

4) Mount the bracket on the wall with provided screw set or adhesive tape.

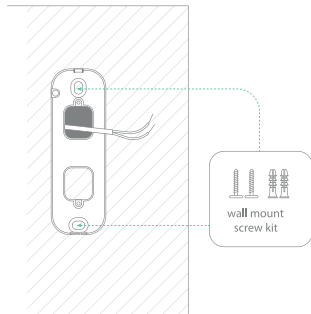

- 5) Attach the wires to the terminals.  
Wire extension kits are optional.

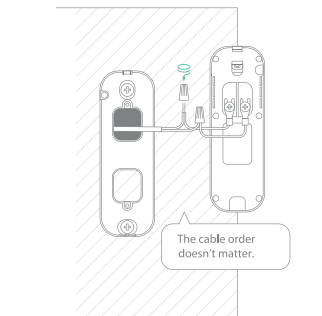

- 6) Feed the wires back to the wall and mount the doorbell to the brackets.

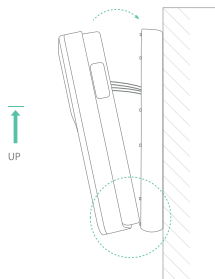

- 7) Restore power at the breaker, and your doorbell is ready for use.

## Wireless installation

- 1) Release the bracket from the doorbell with the provided tool.

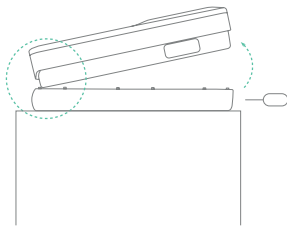

- 2) Mark the screw holes and mount the bracket on your wall with screws.

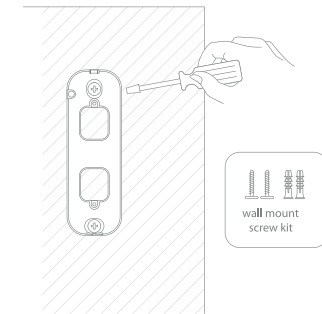

3) Adhesive tape is provided to mount the bracket on flat surfaces. (Optional)

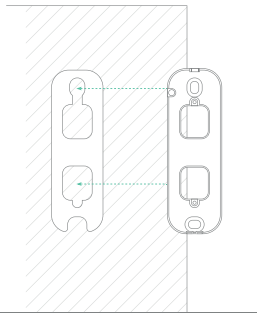

Note

When mounting the doorbell with 3M adhesive pad, in order to improve the adhesive pad's adhesive effect, please wipe the mounting location to ensure that there is no dirt and dust. when the 3M adhesive pad is attached to the wall, you need to press evenly up and down to ensure that the adhesive pad is fully activated.



4) Attach the doorbell to the fixed mounting bracket.

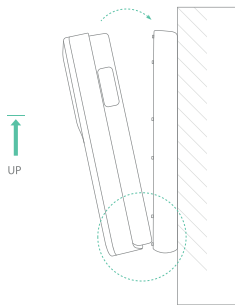

5) All set! Press the doorbell button to run a test.



## Install at an angle (optional)

You can purchase the following angled brackets to point your doorbell to a specific view angle.

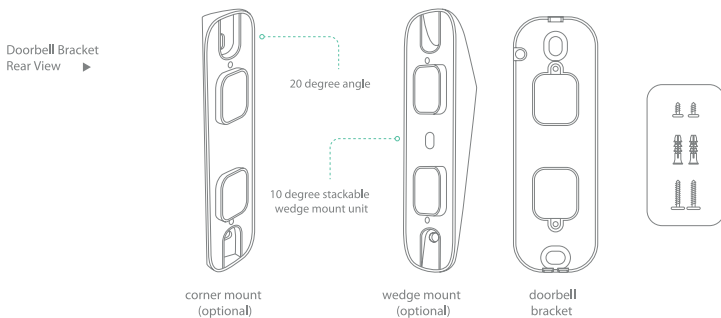

## | Installation steps

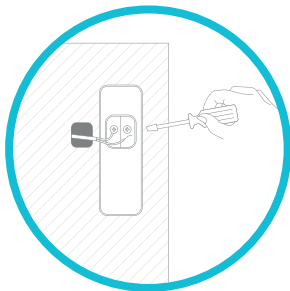

- 1) If you have an existing doorbell, please remove it from the wall and disconnect the wires. Please refer to retrofitting installation steps in P13-15 for your safety.
- 2) Mark the screw holes and mount the angle bracket on your wall with screws.
- 3) Mark the screw holes and mount the plane bracket on the angle bracket with screws.
- 4) After fixing the screws, the installation is completed. For other steps, please refer to the existing doorbell installation steps for retrofitting installation.

schematic diagram ▶

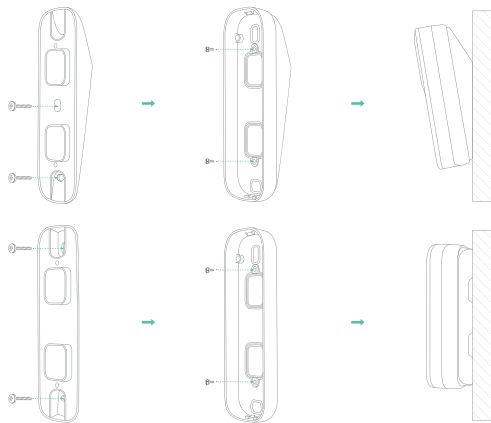

## Detach and alarm

### 1) Anti-theft Tamper Alarm

You can also enable the anti-theft alarm in doorbell settings.

### 2) Tamper Alarm On

With the tamper alarm on, your doorbell detects dismounting activities with the magnet on its back, and then a 30-second siren alarm will be triggered. Meanwhile, video recording will start, and an alarm notification will be pushed to the owner's app account.

### 3) Tamper Alarm Off

You can disable the tamper alarm in doorbell settings, and detach the doorbell without triggering any alarm for battery recharge or regular maintenance.

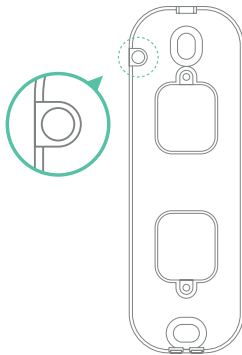

# Product specifications

LED indicator explanation	
Mode	Status
Working mode	Solid blue light
Sleep mode	Off
Charging mode	Solid yellow light
Charging completed	Solid green light
Network setting up mode	Flashing blue light

## I Video doorbell specifications

Item	Specification
Camera	2K Camera
View angle	FOV 160
Image resolution	2048(H) x 1536(V)
Video bitrate	Adaptive
Storage medium	Micro SD card (up to 128 GB)
Battery capacity	5200 mAh/6700 mAh
Adapter requirements	5 V/1.5 A
Dimension	144x46x31 (mm)

## I Wireless chime specifications

Item	Specification
Power port	Micro USB
Ringtone type	Chord music
Number of ringtones	5 ringtones (optional)
Communication protocol	FSK
Adapter requirements	5V/1A or 1.5A
Dimension	65×65×20 (mm)



## Firmware upgrade

When you connect your doorbell via the app, it will automatically detect if there is a new firmware available and prompt for an upgrade. You can also manually detect the firmware upgrade in the app's doorbell settings.

**Note**

Please make sure your doorbell is fully charged or connected to the power adapter before the firmware upgrade, and do not turn off your doorbell during the upgrade process.

## FAQ and troubleshooting

Q: Does the doorbell glow red when using its night vision?

A: It has built-in infrared light beads. Only a faint red light can be seen under the night vision mode, and the camera is still clear in a dark environment.

Q: What are the requirements for Wi-Fi?

A: Please use a 2.4 GHz wireless network. The doorbell does not support the 5 GHz wireless network. Meanwhile, please set the Wi-Fi authentication method to a security method below wpa2-psk, which requires a password.

Q: [How far away from the router should the doorbell be placed?](#)

A: It has been tested that the Wi-Fi connection distance is up to 150 meters in an open environment. The actual situation depends on the Wi-Fi signal strength and the surrounding environment (too thick walls, electromagnetic wave doorbells, and large metal objects can interfere with the Wi-Fi signal). If the doorbell connection signal is weak or unstable, please place the doorbell as close to the router as possible.

Q: [How can I review videos in a quick and categorized way?](#)

A: Click the icon on the top left corner of the "Library" screen to set filtering conditions, check the conditions and save them to quickly review the video playback by category.

Q: [What should I do when the doorbell acts abnormally?](#)

A: After taking the doorbell off the bracket, press and hold the power button for 3 seconds to reboot it. If it doesn't respond, you can reset the doorbell by poking the reset hole with a pin.



AI for everyone and everything.