

NVS-D3D

Wireless Door / Window Contact

Box Content

- 1 x Door / Window Contact
- 1 x User Manual
- 3 x Distance Holder

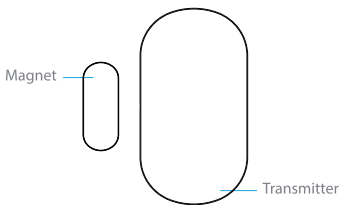

Distance Holder

There are 3 sizes distance holder in the package, it is clickable to each to reach more distance options, for different window frame depths where user will mount the Magnet.



Heights(mm)	Holder
3	A
5	B
14.5	C
8	A+B
17.5	A+C
19.5	B+C
22.5	A+B+C

Installation

- Open the case and remove the battery activation strip.
- Mount the sensor on the door and the magnet on the door frame.
- Make sure the magnet is placed above of the transmitter.
- Mount the magnet max. 1cm away from the transmitter and secure the transmitter and magnet with double-sided tape or screws.
- Avoid mounting the sensor in areas with a large amount of metal or electrical wiring, such as a furnace or utility room.

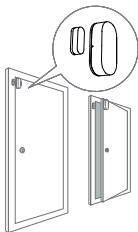

Register the detector in the alarm system

Switch to Connection Mode on the control panel. Separate the magnet of the detector from its transmitter. The control panel beeps once: the detector is registered. If you hear two beeps, the detector has already been connected.

To check if the registration is complete, arm the system and separate the magnet from the transmitter again by opening the door or window on which it is installed. If the siren rings out, the registration is successful.

PCB Layout

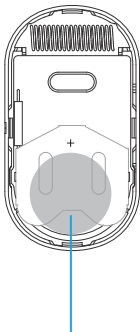

CR2477 3V Battery

Specifications

Power Supply

DC3V
(CR2477 3V Battery x 1)

Static current

<10 uA

Alarm current

<15 mA

Transmission distance

≤ 80 m (in open area)

Radio-frequency

433.92MHz (±75KHz)

Housing material

ABS plastic

Operating conditions

Temperature:

-10°C ~ +55°C

Relative Humidity: ≤80%
(non-condensing)

Transmitter dimensions

55.7 x 30.3 x 16 mm

Magnet dimensions

25 x 10 x 9 mm

LED indications

Blinks once

The door or window is open and the transmitter sends a signal to the control panel.

Blinks quickly

Low power indication: the batteries must be replaced.

Standards



This product bears the selective sorting symbol for waste electrical and electronic equipment (WEEE). This means that this product must be handled pursuant to European Directive 2012/19/EU in order to be recycled or dismantled to minimize its impact on the environment. For further information, please contact your local or regional authorities. Electronic products not included in the selective sorting process are potentially dangerous for the environment and human health due to the presence of hazardous substances.



In compliance with European laws. This product is in compliance with the essential requirements and other relevant provisions of Directive 2014/53/EU (RED)



This product was designed and manufactured in compliance with Directive 2011/65/EU of the European Parliament and of the Council on the restriction of use of certain hazardous substances in electrical and electronic equipment (RoHS Directive - RoHS) and is deemed to comply with the maximum concentration values set by the European Technical Adaptation Committee (TAC).

Manufactured in China.

