



# Electric Strike User Manual ASF702

CE FC RoHS

Read the manual before usage and keep for future reference.

## ※ Product Overview

The electric strike has the similar working principle as the electric bolt lock, it must work with the mechanical lock, so the range of application is small. And it is often used for ordinary wooden door, with the notch of strike sucking the bolt of door, it can lock or open the door. By embedded installing, our products looks excellent. The electromagnetic part is made of high quality magnetic material and adopted specially technology processing, thereby there is no residual magnetism after long time working, then can prove the normal use of the strikes. Moreover, our strikes can support the door with 90 degree opened. At last, with hardness stainless steel material, our strike can bear 500kg impact pressure.

## ※ Parameter

- ◆ lock Size:124Lx32Wx35H(mm)
- ◆ Holding Stength:500KG
- ◆ Lock Structure:Surface by coating nickel
- ◆ Input Voltage:DC12V $\pm$ 10%
- ◆ Working Current:200mA
- ◆ Door Type Applicable:Wooden Door,Metal Door,PVC Door
- ◆ Security Type:Lock When Power Off(Standard)  
Unlock When Power Off(Customizable)

## ※ Installation drawing

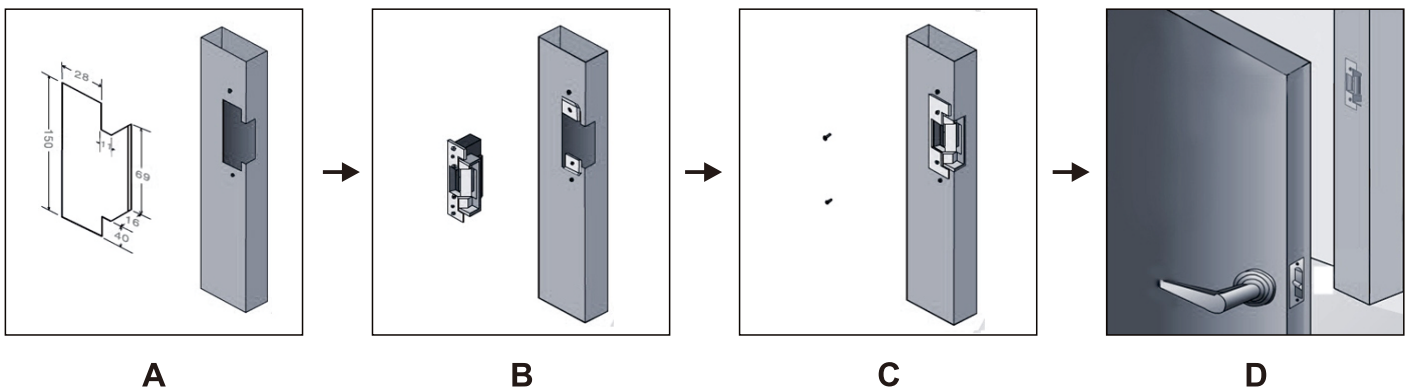

## ※ Size chart

